

TECHNICAL DOCUMENT

150mm GT EPS LOADSPAN

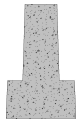

Beam Reference	Depth	Breadth At Bottom	Breadth At Top	Ledge
L13	150 mm	92 mm	42 mm	20 mm
Depth Of Flange	Bottom Splay	Up Splay	Weight	Weight
50 mm	2 mm	3 mm	25 kg/m	0.212 kN/m

The below tables are for informative purposes only, for further information please contact Litecast on 02746 356161, alternatively email sales@litecast.co.uk

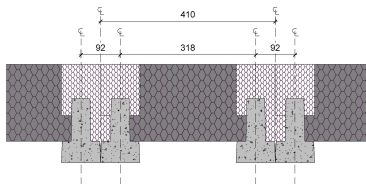
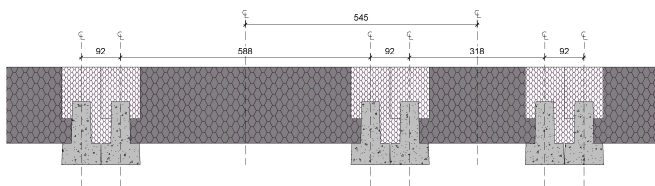
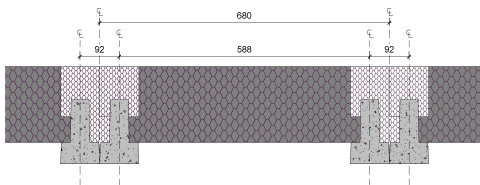
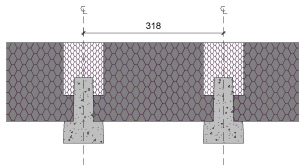
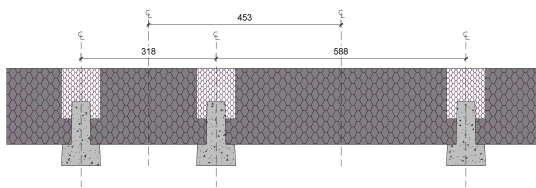
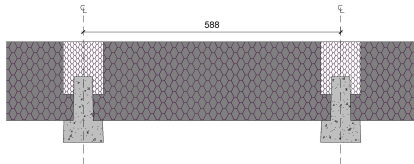

Configuration	S588		EPS Density		20 kg/m³	
Topping	1.725 kN/m²		Partitions		Nil	
Imposed Load (kN/m²)	1.5	2	2.5	3	4	5
Max. Clear Span (mm)	4172	3879	3668	3475	3164	2922

Configuration	S453		EPS Density		20 kg/m³	
Topping	1.725 kN/m²		Partitions		Nil	
Imposed Load (kN/m²)	1.5	2	2.5	3	4	5
Max. Clear Span (mm)	4717	4413	4159	3944	3596	3325

Configuration	S318		EPS Density		20 kg/m³	
Topping	1.725 kN/m²		Partitions		Nil	
Imposed Load (kN/m²)	1.5	2	2.5	3	4	5
Max. Clear Span (mm)	5300*	5159	4876	4635	4241	3932

*Beams are not manufactured over 5.5m in length, max clear span has been adjusted to suit based on 100mm of bearing at each end.

bearing at each end:						
Configuration	D680		EPS Density		20 kg/m³	
Topping	1.725 kN/m²		Partitions		Nil	
Imposed Load (kN/m²)	1.5	2	2.5	3	4	5
Max. Clear Span (mm)	5300*	5008	4731	4495	4111	3809*

*Beams are not manufactured over 5.5m in length, max clear span has been adjusted to suit based on 100mm of bearing at each end.

Loading at each end:						
Configuration	D545		EPS Density		20 kg/m³	
Topping	1.725 kN/m²		Partitions		Nil	
Imposed Load (kN/m²)	1.5	2	2.5	3	4	5
Max. Clear Span (mm)	5300*	5300*	5230	4975	4559	4231

*Beams are not manufactured over 5.5m in length, max clear span has been adjusted to suit based on 100mm of bearing at each end.

bearing at each end.						
Configuration	D410		EPS Density		20 kg/m³	
Topping	1.725 kN/m²		Partitions		Nil	
Imposed Load (kN/m²)	1.5	2	2.5	3	4	5
Max. Clear Span (mm)	5300*	5300*	5300*	5300*	5171	4812

*Beams are not manufactured over 5.5m in length, max clear span has been adjusted to suit based on 100mm of bearing at each end.

TECHNICAL DOCUMENT

150mm GT EPS LOADSPAN

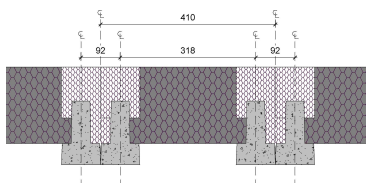
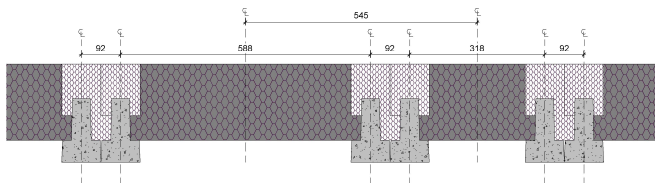
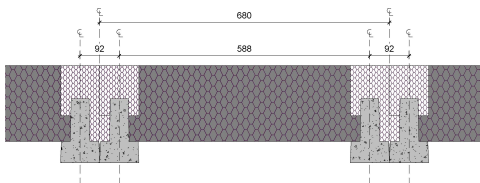
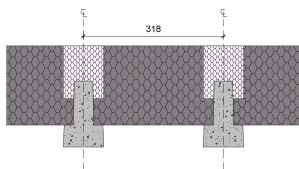
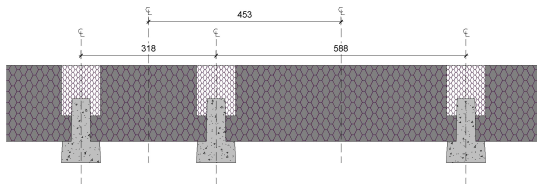
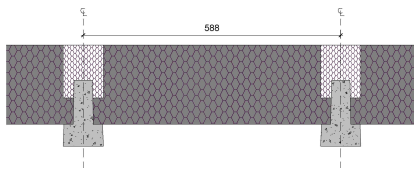

Configuration	S588		EPS Density		20 kg/m ³	
Topping	1.725 kN/m ²		Partitions		0.5 kN/m ²	
Imposed Load (kN/m ²)	1.5	2	2.5	3	4	5
Max. Clear Span (mm)	3974	3733	3530	3356	3073	2849

Configuration	S453		EPS Density		20 kg/m ³	
Topping	1.725 kN/m ²		Partitions		0.5 kN/m ²	
Imposed Load (kN/m ²)	1.5	2	2.5	3	4	5
Max. Clear Span (mm)	4498	4231	4005	3811	3494	3244

Configuration	S318		EPS Density		20 kg/m ³	
Topping	1.725 kN/m ²		Partitions		0.5 kN/m ²	
Imposed Load (kN/m ²)	1.5	2	2.5	3	4	5
Max. Clear Span (mm)	5254	4956	4704	4485	4125	3838

Configuration	D680		EPS Density		20 kg/m ³	
Topping	1.725 kN/m ²		Partitions		0.5 kN/m ²	
Imposed Load (kN/m ²)	1.5	2	2.5	3	4	5
Max. Clear Span (mm)	5101	4810	4562	4349	3997	3718

Configuration	D545		EPS Density		20 kg/m ³	
Topping	1.725 kN/m ²		Partitions		0.5 kN/m ²	
Imposed Load (kN/m ²)	1.5	2	2.5	3	4	5
Max. Clear Span (mm)	5300*	5300*	5048	4817	4436	4132

*Beams are not manufactured over 5.5m in length, max clear span has been adjusted to suit based on 100mm of bearing at each end.

Configuration	D410		EPS Density		20 kg/m ³	
Topping	1.725 kN/m ²		Partitions		0.5 kN/m ²	
Imposed Load (kN/m ²)	1.5	2	2.5	3	4	5
Max. Clear Span (mm)	5300*	5300*	5300*	5300*	5036	4703

*Beams are not manufactured over 5.5m in length, max clear span has been adjusted to suit based on 100mm of bearing at each end.