

Litecast Beam & Block

LOADSPAN TABLE – 150mm BEAM

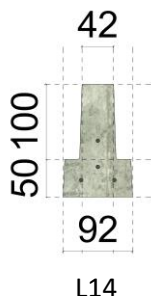

Beam Reference	Height (mm)	Width (mm)	Weight (kg/m)	Weight (kN/m)
L14	150	92	24	0.235

The loadspan tables shown below are for illustrative purposes only. Beams used in conjunction with 1950kg/m³ dense blocks. For further information please contact Litecast Homefloors on: 02476 356 161



S488	Finishes = 1.425 kN/m ²					
	Imposed load kN/m ²					
Self Weight	1.5	2	2.5	3	4	5
kN/m ²	Maximum Clear Span (m)					
2.17	4.04	3.81	3.65	3.51	3.26	3.06

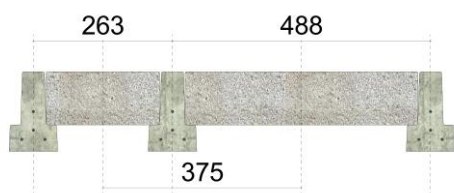

S375	Finishes = 1.425 kN/m ²					
	Imposed load kN/m ²					
Self Weight	1.5	2	2.5	3	4	5
kN/m ²	Maximum Clear Span (m)					
2.25	4.54	4.34	4.15	3.99	3.72	3.49

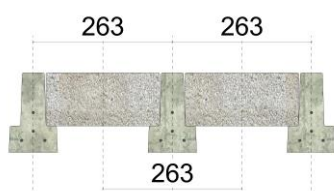

S263	Finishes = 1.425 kN/m ²					
	Imposed load kN/m ²					
Self Weight	1.5	2	2.5	3	4	5
kN/m ²	Maximum Clear Span (m)					
2.40	5.37	5.13	4.92	4.74	4.42	4.16

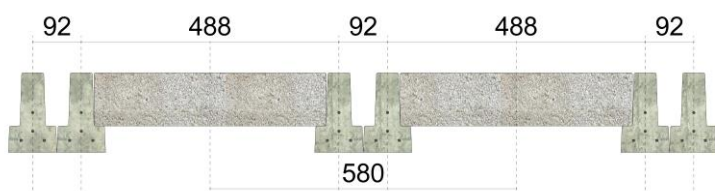

D580	Finishes = 1.425 kN/m ²					
	Imposed load kN/m ²					
Self Weight	1.5	2	2.5	3	4	5
kN/m ²	Maximum Clear Span (m)					
2.39	5.11	4.89	4.69	4.51	4.21	3.96

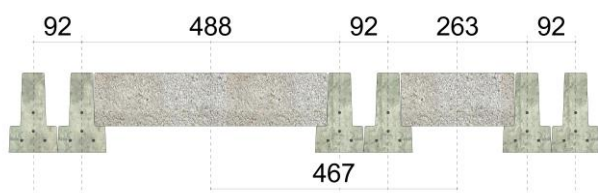

D467	Finishes = 1.425 kN/m ²					
	Imposed load kN/m ²					
Self Weight	1.5	2	2.5	3	4	5
kN/m ²	Maximum Clear Span (m)					
2.5	5.65	5.40	5.19	5.00	4.67	4.39

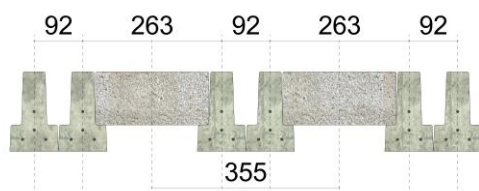

D355	Finishes = 1.425 kN/m ²					
	Imposed load kN/m ²					
Self Weight	1.5	2	2.5	3	4	5
kN/m ²	Maximum Clear Span (m)					
2.69	6.30	6.12	5.88	5.67	5.30	5.00